

Pulsation damper

Diaphragm-pulsation damper
up to 10 bar

810.1-0,16/10 – 810.1-2,0/10



810.1-0,16/10 - 810.1-2,0/10 in survey

- Compact design
- Easy to operate
- Low maintenance
- Long service life
- Easy to install
- Design acc. to 97/23/EG
- High-quality materials

Technical data

Type	Max. admissible operating pressure		Content	
	bar	psi	Litres	Gallons
810.1-0,16/10	10	145	0,16	0,042
810.1-0,32/10	10	145	0,32	0,085
810.1-0,75/10	10	145	0,75	0,198
810.1-2,0/10	10	145	2,00	0,528

Dimensional drawing

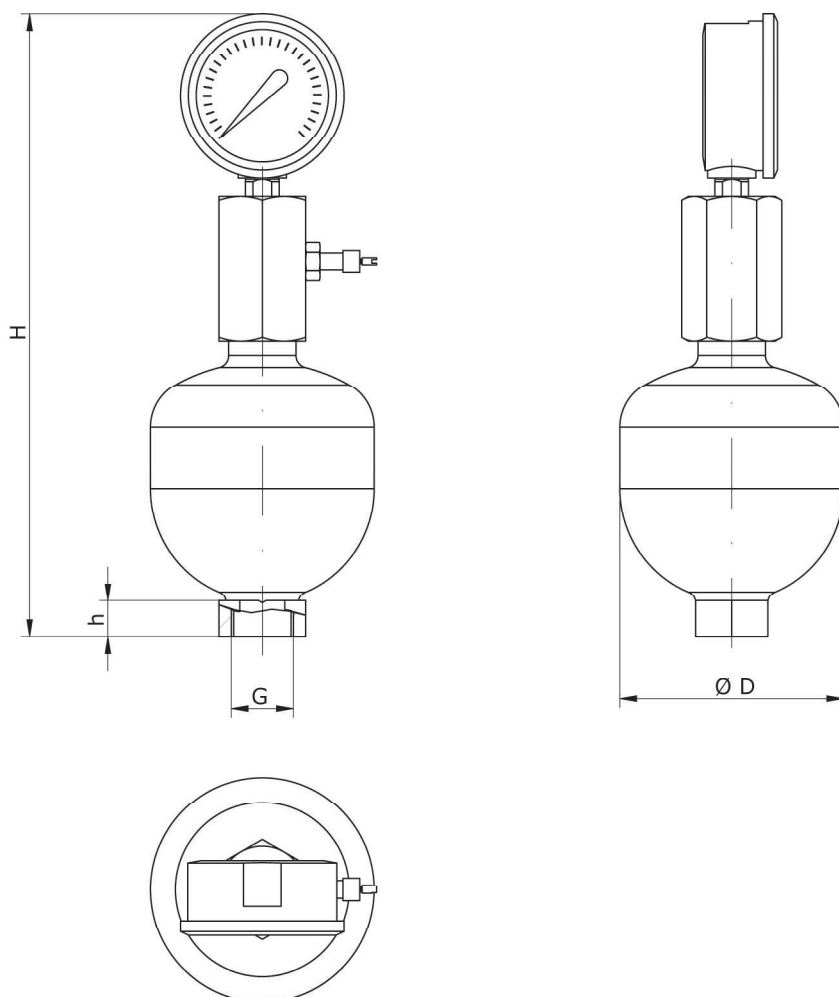

Dimensional chart

Indications in mm / inch

Type	G	D		h		H		Weight (kg)
		mm	in	mm	in	mm	in	
810.1-0,16/10	G 1/2	74	2,91	14	0,55	245	9,65	0,8
810.1-0,32/10	G 1/2	93	3,66	14	0,55	260	10,24	1,3
810.1-0,75/10	G 1/2	212	8,35	14	0,55	290	11,24	2,8
810.1-2,0/10	G 3/4	160	6,30	18	0,71	340	13,39	4,0

■ Indication of weight for basic design acc. to order information

Order information



Diaphragm-pulsation damper

Basic design:

- with filling and measuring device up to 10 bar (145 psi), plastic design
- Manometer d63, 0-16 bar (232 psi), measuring system copper-alloy



Type	Thread connection	Material		
		1.4571/Butyl Art.-Nr.	1.4571/FPM Art.-Nr.	1.4571/PTFE Art.-Nr.
810.1-0,16/10	G 1/2	37603720	37603724	–
810.1-0,32/10	G 1/2	37603721	37603725	–
810.1-0,75/10	G 1/2	37603722	37603726	37606307
810.1-2,0/10	G 3/4	37603723	37603727	37606308

Options/Accessories		810.1-0,16/10 up to 810.1-2,0/10
<p>Filling pump FLP 2</p>  <p>for filling device, max. 7 bar (101 psi), with manometer, 2 m (6,5 ft) hose, coupling piece for air hose</p>		90009396
<p>Filling and pressure measuring devices</p> 	<p>mounted on pulsation damper:</p> <hr/> <p>Plastic design</p> <p>Manometer 0-16 bar (232 psi), measuring system copper alloy</p> <hr/> <p>Stainless steel design</p> <p>Manometer 0-16 bar (232 psi), glycerine damped, housing 1.4301, measuring system copper alloy</p>	

810.1-0,16/180 – 810.1-2,0/100



810.1-0,16/180 to 810.1-2,0/100 in survey

- Compact design
- Easy to operate
- Low maintenance
- Long service life
- Easy to install
- Design acc. to 97/23/EG
- High-quality materials

Technical data

Type	Max. admissible operating pressure		Content	
	bar	psi	Litres	Gallons
810.1-0,16/180	180	2610	0,16	0,042
810.1-0,32/160	160	2320	0,32	0,085
810.1-0,75/140	140	2030	0,75	0,198
810.1-2,0/100	100	1450	2	0,528

Dimensional drawing

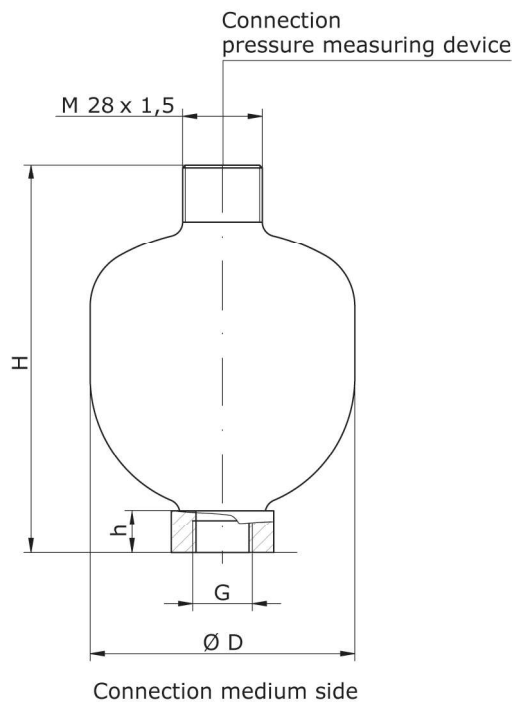

Dimensional chart

Indications in mm / inch

Type	G	D		h		H		Weight kg
		mm	in	mm	in	mm	in	
810.1-0,16/180	G 1/2	74	2,91	14	0,55	124	4,88	0,8
810.1-0,32/160	G 1/2	93	3,66	14	0,55	137	5,39	1,3
810.1-0,75/140	G 1/2	212	8,35	14	0,55	168	6,61	2,8
810.1-2,0/100	G 3/4	160	6,30	18	0,71	218	8,58	4

■ Indication of weight for basic design acc. to order information

Order information

Diaphragm-pulsation damper



Basic design

■ Connection: internal thread

Type	Thread connection	Material		
		1.4571/Butyl Art.-Nr.	1.4571/FPM Art.-Nr.	1.4571/PTFE Art.-Nr.
810.1-0,16/180	G 1/2	90008811	90009498	--
810.1-0,32/160	G 1/2	90010409	90010983	--
810.1-0,75/140	G 1/2	37600313	37600148	37606302
810.1-2,0/100	G 3/4	37600314	37600149	37606303

Options/Accessories

**810.1-0,16/180
up to
810.1-2,0/100**

Filling and pressure measuring devices

Design:
removable
manometer d63, plastic housing, measuring system copper-alloy,
2,5 m (8,2 ft) filling hose, connection M14x1,5



0 bar - 25 bar (362,5 psi)

37601674

0 bar - 100 bar (1450 psi)

37601673

0 bar - 250 bar (3625 psi)

30066005