

# DRY MATERIAL FEEDER

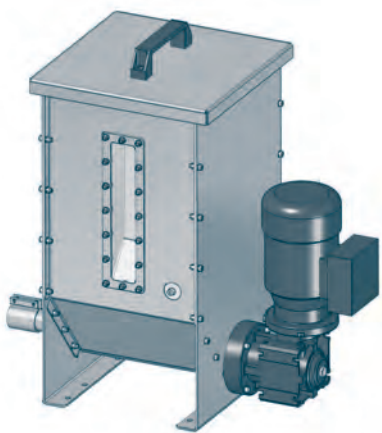

## OVERVIEW

- Compact design
- Linear performance curves
- For pourable, non-bridging media
- High dosing accuracy
- Mounted-on ribbon pan
- Sealing between filling space and drive
- No-maintenance
- Easy to operate

## TECHNICAL DATA

GENERAL DATA			DMF-5.2	DMF-20.2	DMF-50.2	DMF-200.2
Feed rate	l/h		5	20	50	200
Drive power	kW		0,09	0,18	0,09	0,18
Speed	min <sup>-1</sup>		17	68	17	68
Dry material	density	kg/ltr.	0,5...1,2	0,5...1,2	0,5...1,2	0,5...1,2
	grain size	mm	1,5	1,5	1,5	1,5
Vorratsvolumen	litres		35	35	35	35
Weight (empty)	kg		30	30	30	30

## BASIC DESIGNS

### DMF-... .2

Type		Price (EUR)
DMF-5.2	25002778	☉
DMF-20.2	25002745	☉
DMF-50.2	25002748	☉
DMF-200.2	25002780	☉

## DIMENSIONS

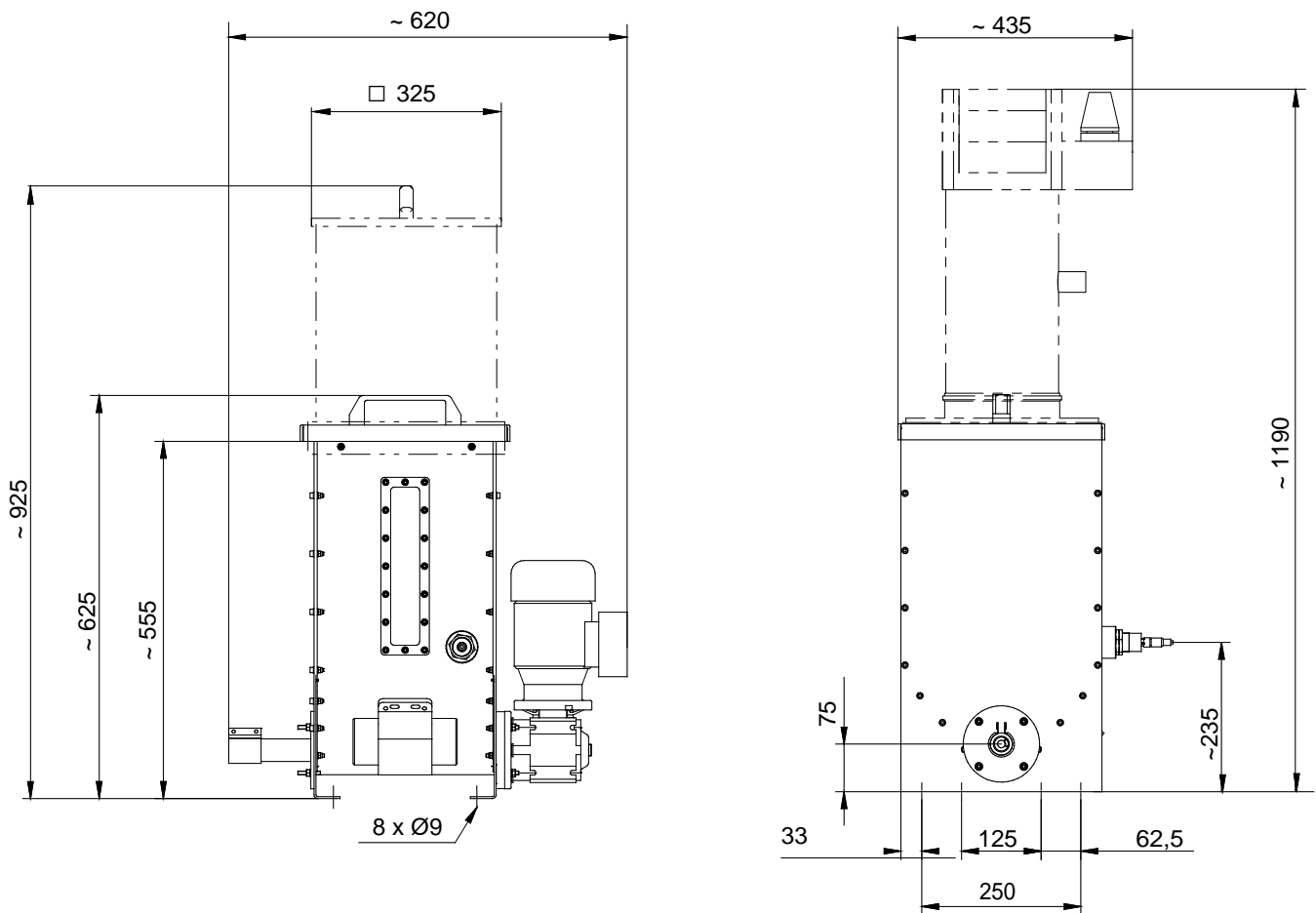

## OPTIONS/ACCESSORIES

		Price [EUR]
Hopper extension	volume expansion: 25 litres	▲
Sensors	empty signal for hopper	▲
Electric external vibrator	0,045 kW, 230V, 50Hz, IP65, ISO-Class F	▲
Conveyor unit	incl. hose package and suction pipe	▲
DMF - ... EB	with integrated control electronics	▲